

37
P11-177
1/205

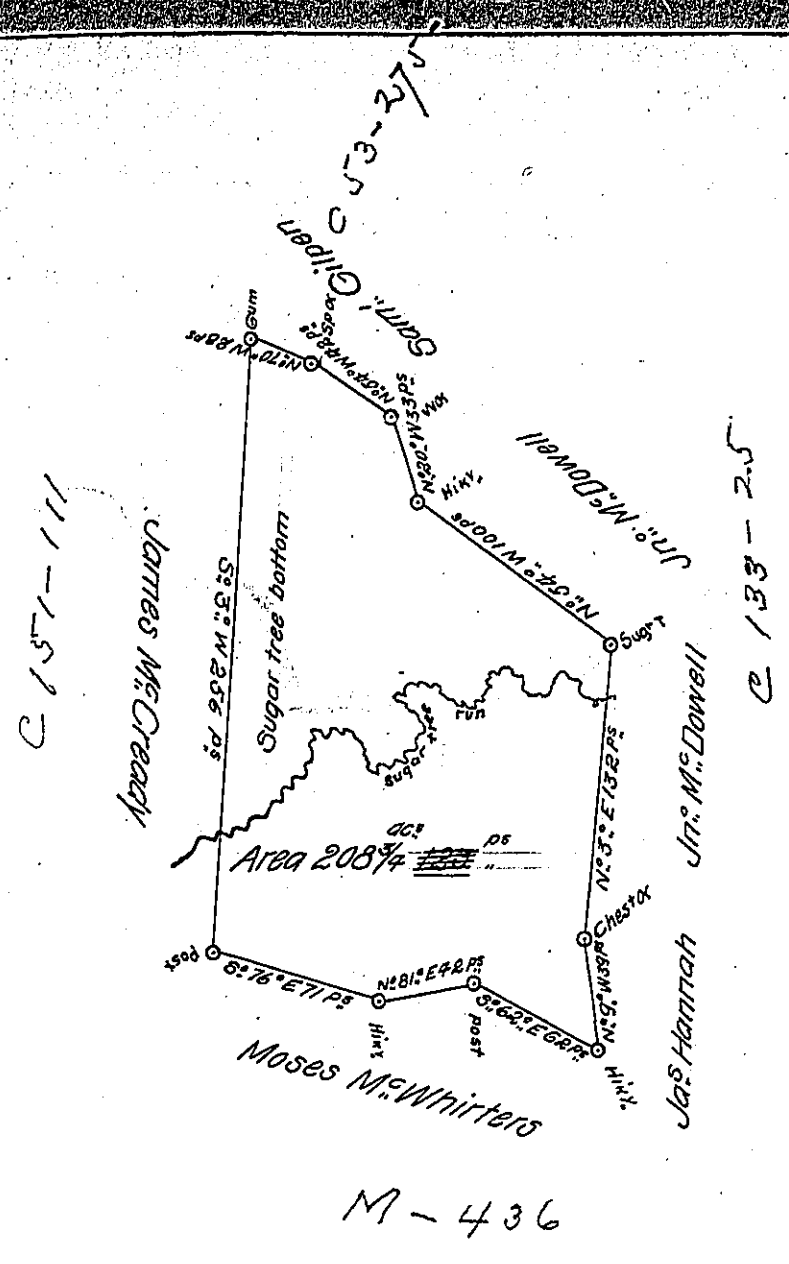

~~Notes to list of entries~~
~~to be made~~
~~in the~~
~~County~~
~~of~~
~~Washington~~
~~County~~
~~Pa.~~

Ent. 27th March 1780

Ret. 15th May 1787

A Draught of a Survey called "Sugar Tree Bottom" situate on the waters of Chartiers Creek in Washington County cont^g 208 Ac^s 123 P^s strict Measure executed Feb^y 17th 1786 for James Hughes Ass^{ts} of Isaac Israel in consequence of a certif^d for 400 ac^s granted to s^d Isaac Israel by the commiss^{rs} appointed by Virg^a to adjust the claims to unpatented Lands in the counties Monong^a Yohg^a and Ohio and duly entered with the County Surv^r as appears from the dist of Entries transmitted from the Surv Gen^{ls} Office

Jr^o Lukens Esq^r Sr Gen^l

Presley Nevill }
 Matt^w Ritchie } D^{ss}

IN TESTIMONY that the above is a copy of the original remaining on file in the Department of Internal Affairs of Pennsylvania, made conformably to an Act of Assembly approved the 16th day of February, 1833, I have hereunto set my Hand and caused the Seal of said Department to be affixed at Harrisburg, this twelfth day of JANUARY 1905

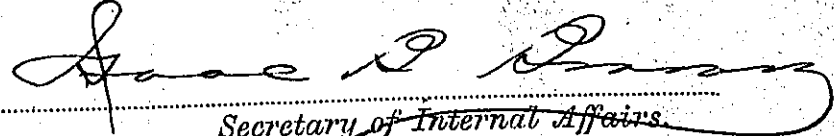
 Secretary of Internal Affairs